

RoHS Lead-free

Specifications :

- Voltage rating: 30V AC / DC
- Current rating: 0.2A AC / DC
- Withstanding voltage: 200V AC/minute
- Temperature range: -25°C~+85°C
- Insulation resistance: ≥100MΩ
- Contact resistance: ≤30mΩ
- After environmental testing: ≤40mΩ

0600 H I-XX X- LP XX HF

① ② ③ ④ ⑤ ⑥ ⑦ ⑧

- ① Series No.
- ② Category: H-HSG
- ③ Welding Board Angle: I-HSG+hardware
- ④ Row No.-Pin No.: XX-Single row ;
- ⑤ Plating style: Blank-Tin plating, G-Gold plated
- ⑥ Material: LP-LCP 94V-0
- ⑦ Color: Blank-natural color
- ⑧ HF-Halogen free

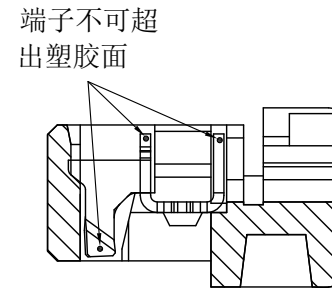
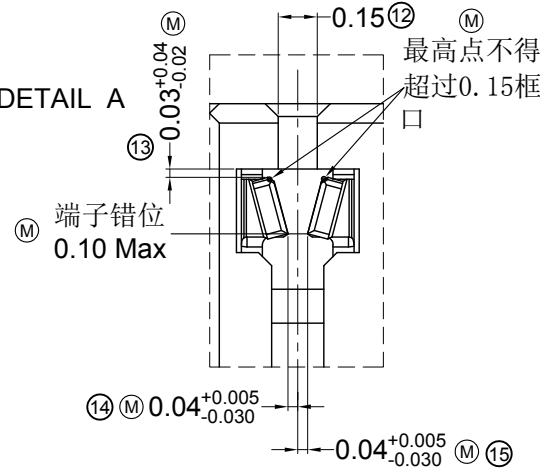
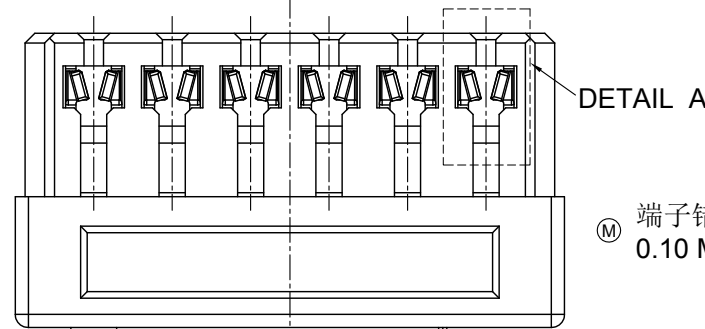
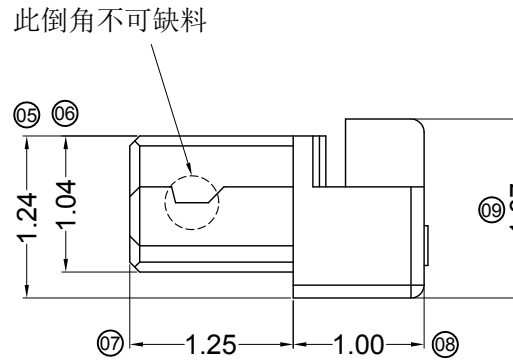
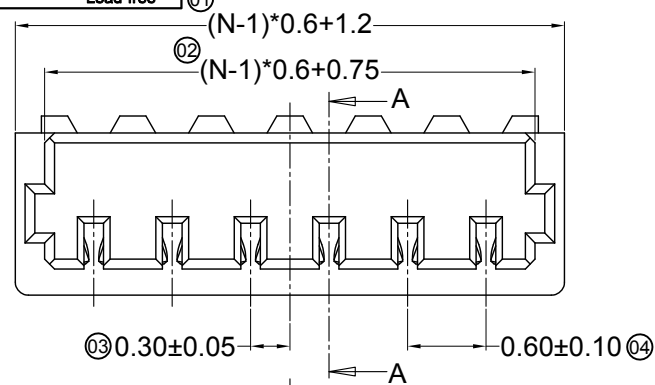

SECTION A-A
SCALE 1 : 1

DETAIL A
SCALE 2 : 1

AWG	Dimensions(mm)	
	E	F
AWG#36	0.11	0.09
AWG#34	0.12	0.12

PART NO	Material	Wire Range	Insulation O.D.	Material(Terminal)	Finish(Terminal)	Mates With SWB Wafer	Q'ty/Reel
0600HI-XX-LPBKHF	LCP UL94V-0 Halogen Free (Black)	AWG#36/AWG#34	0.29mm(Max)	Phosphor Bronze	Tin-Plated	0600W	1,000Pcs
0600HI-XX-LPHF	LCP UL94V-0 Halogen Free	AWG#36/AWG#34	0.29mm(Max)	Phosphor Bronze	Tin-Plated	0600W	1,000Pcs
0600HI-XXG-LPHF	LCP UL94V-0 Halogen Free	AWG#36/AWG#34	0.29mm(Max)	Phosphor Bronze	Gold-Flash	0600W	1,000Pcs
0600HI-XX-LP	LCP UL 94V-0	AWG#36/AWG#34	0.29mm(Max)	Phosphor Bronze	Tin-Plated	0600W	1,000Pcs
0600HI-XXG-LP	LCP UL 94V-0	AWG#36/AWG#34	0.29mm(Max)	Phosphor Bronze	Gold-Flash	0600W	1,000Pcs

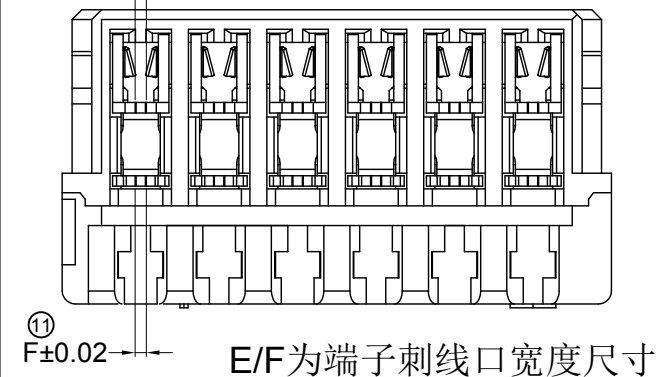

DATE	OLD REV	NEW REV	ECN	DESCRIPTION	CHECK	APPROVAL	PROJECT	APPROVAL	CHECK	DRAWN	DATA	UNIT	SCALE	NUMBER	REV
2014/02/12	A	B		Add Black Part No	Jova					Allen	2013/07/31	MM	1 : 1	A-106	B

GENERAL TOLERANCE
.X ±0.30
.XX ±0.20
.XXX ±0.10

SWB 思索连接器有限公司
Terminal & Connectors SWB CONNECTORS CO., LTD

PART NO. 0600HI-XXX-LPXXXX
TITLE 0.60mm Crimp Style Connectors

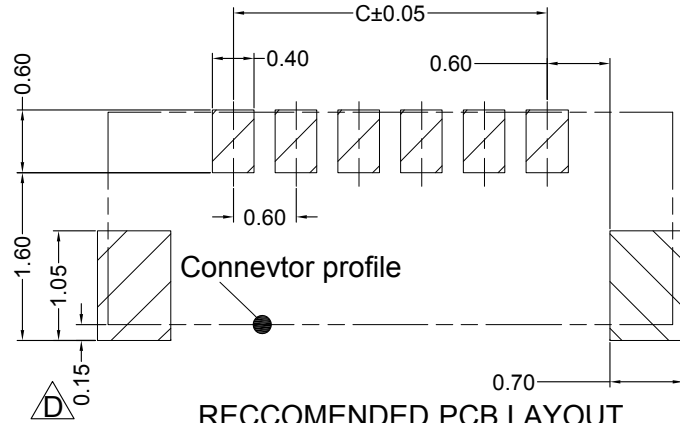
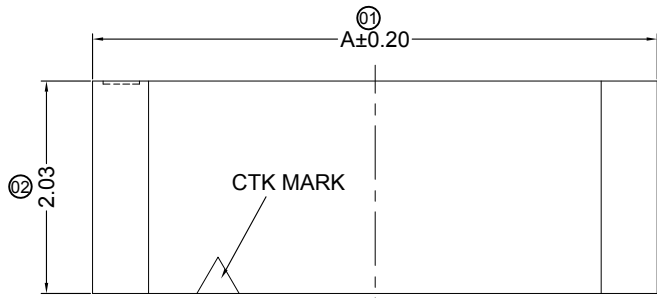

RECCOMENDED PCB LAYOUT
DEFAULT TOL:±0.05

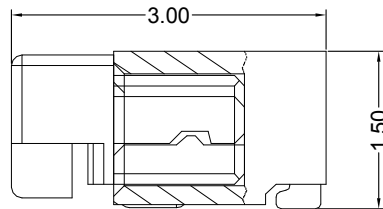
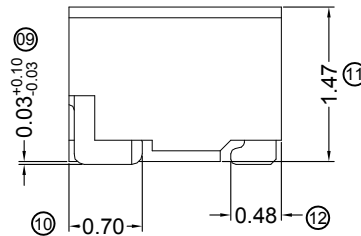
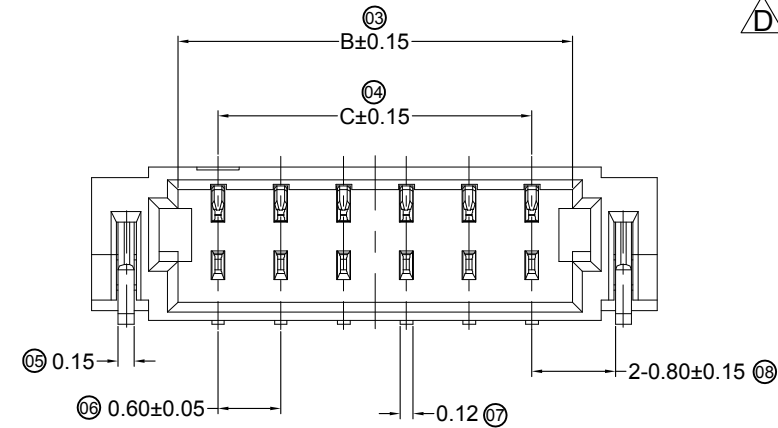

MATED

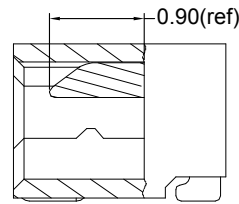

Specifications :

- Voltage rating: 30V AC / DC
- Current rating: 0.2A AC / DC
- Withstanding voltage: 200V AC/minute
- Temperature range: -25°C~+85°C
- Insulation resistance: ≥100MΩ
- Contact resistance: ≤30mΩ

0600 W R S - XX X - XX XX XX

① ② ③ ④ ⑤ ⑥ ⑦ ⑧ ⑨

- ① Series No.
- ② Category: W-wafer
- ③ Welding Board Angle:R-90°
- ④ Welding Way:S-SMT
- ⑤ Row No.-Pin No. :XX-Single row
- ⑥ Plug the Pin & Special NO.
- ⑦ Material: LP-LCP
- ⑧ Planting Category:
V:All Gold-Plated
*01-Gold Flash ; *02-2u" ; *03-3u"
*05-5u" *10-10u" *15-15u"
SN-Bright tin plating 70-120u"
SW-Fog Tin plating
HS-High temperature Tin
- ⑨ Color:
Blank-natural color

N	C+2.4	C+0.78	(N-1)*0.6
12	9.00	7.38	7.20
10	7.80	6.18	6.60
8	6.60	4.98	4.20
6	5.40	3.78	3.00
4	4.20	2.58	1.80
CKTS	DIM A	DIIM B	DIM C

PART NO	Material	Material(Pin)	Finish(Pin)	Material (Solder Tabs)	Finish (Solder Tabs)	Mates With SWB Housing	Q'ty/Bag
0600WRS-XX-LPV01	LCP UL 94V-0 BLACK	Phosphor Bronze	Gold-Flash	Brass	Gold-Flash	0800H	1,000Pcs
0600WRS-XX-LPV01	LCP UL 94V-0	Phosphor Bronze	Gold-Flash	Brass	Gold-Flash	0800H	1,000Pcs
0600WRS-XX-LPSN	LCP UL 94V-0	Phosphor Bronze	Tin-Plated	Brass	Tin-Plated	0800H	1,000Pcs

DATE	OLD REV	NEW REV	ECN	DESCRIPTION	CHECK	APPROVAL	PROJECT
2014/06/12	C	D		Add PCB LAYOUT SIZE	Jova		GENERAL TOLERANCE .X ±0.30 .XX ±0.20 .XXX ±0.10
2014/02/10	B	C		Add Black Part No	Jova		
2014/01/06	A	B		Modification Title Explain	Jova		

SWB 思索连接器有限公司
Terminal & Connectors SWB CONNECTORS CO.,LTD

APPROVAL	CHECK	DRAWN	DATA
Bob	Jova	Song Li	2012/08/06

PART NO. 0600WRS-XX-LPXX			
TITLE 0.60mm Crimp Style Connectors			
UNIT	SCALE	NUMBER	REV
MM	1:1	A-106	D

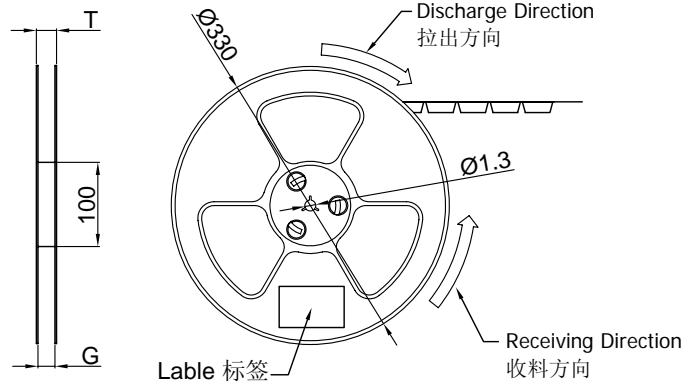
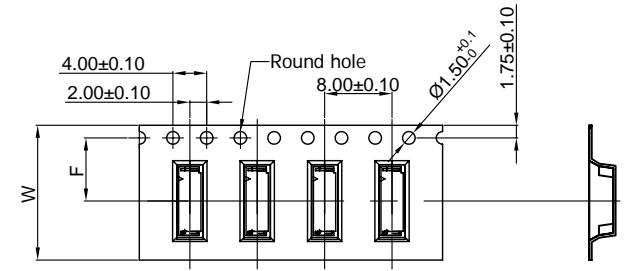
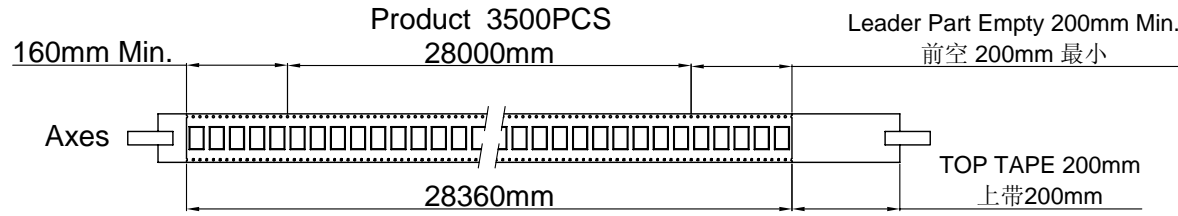

COVER TAPE PEEL STRENGTH:20~120g
上带剥离力量:20~120g
速度 PEEL SPEED:300mm/minute

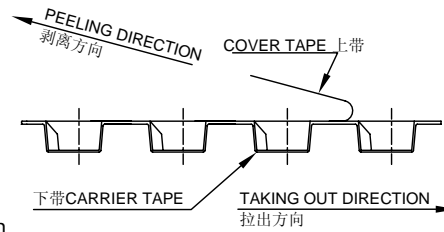

Single hole: None Hole Side
单孔: 贴无链孔侧
Double hole: Elliptical Hole Side
双孔: 贴椭圆孔侧

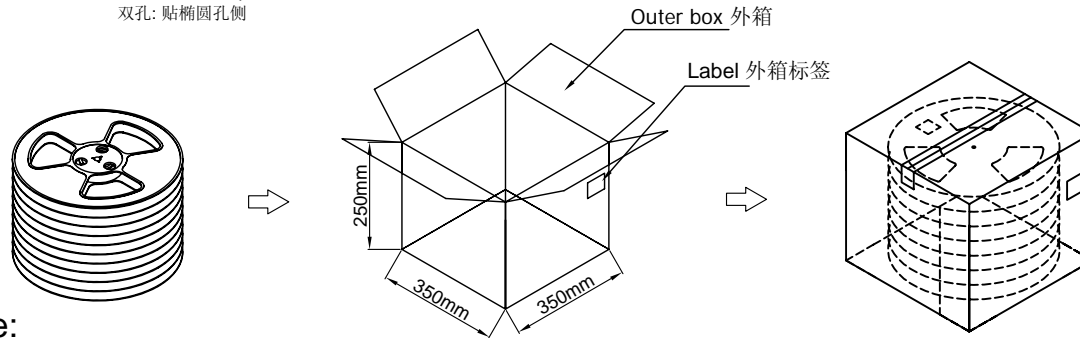

Note:

- Carrier Camber Is Within 1mm In 100mm ; 带长100mm内容许弯曲度1mm
- 10 Sprocket Hole Pitch Cumulative Tolerance±0.2MM ; 圆孔十个孔距离累计允许公差为±0.2mm
- Material for PS ; 材质为PS材质
- Thickness=0.30±0.05 ; 材料厚度为0.30±0.05mm

Part No.	W	S	F	T (MAX)	G(MAX)	REEL /PCS	CARTON /R	CARTON /PCS
ZD0600WRS-02								
ZD0600WRS-03	12	/	5.50	16.50	12.40	3500	13R	45.5K
ZD0600WRS-04								
ZD0600WRS-05								
ZD0600WRS-06								
ZD0600WRS-07	16	/	7.50	20.50	16.40	3500	11R	38.5K
ZD0600WRS-08								
ZD0600WRS-09								
ZD0600WRS-10								
ZD0600WRS-11								
ZD0600WRS-12								
ZD0600WRS-13								
ZD0600WRS-14								
ZD0600WRS-15	24	/	11.50	28.50	24.40	3500	8R	28K
ZD0600WRS-16								
ZD0600WRS-17								
ZD0600WRS-18								
ZD0600WRS-19								
ZD0600WRS-20								

DATE	OLD REV	NEW REV	ECN	DESCRIPTION	CHECK	APPROVAL	PROJECT	APPROVAL	CHECK	DRAWN	DATA	UNIT	SCALE	NUMBER	REV
												MM	1:1	A-106	A

GENERAL TOLERANCE
.X ±0.30
.XX ±0.20
.XXX ±0.10



思索连接器有限公司
SWB CONNECTORS CO.,LTD

PART NO. PPN: 0600WRS-XX-XXXX
CPN: ZD0600WRS-XX

TITLE
0.60mm Connectors SMT 90° Package

APPROVAL: Allen
CHECK: Allen
DRAWN: Allen
DATA: 2013/12/09