

RoHS  Lead-free

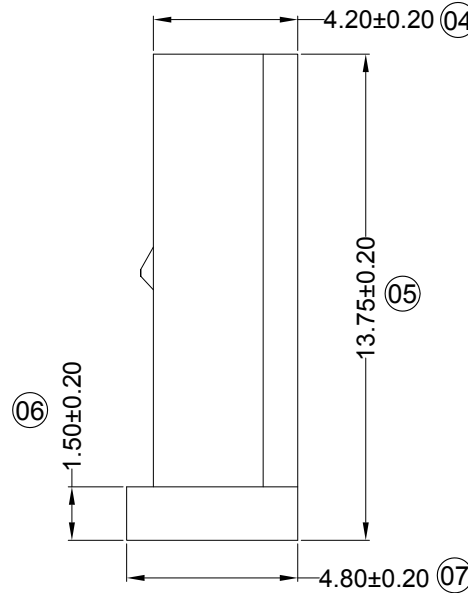
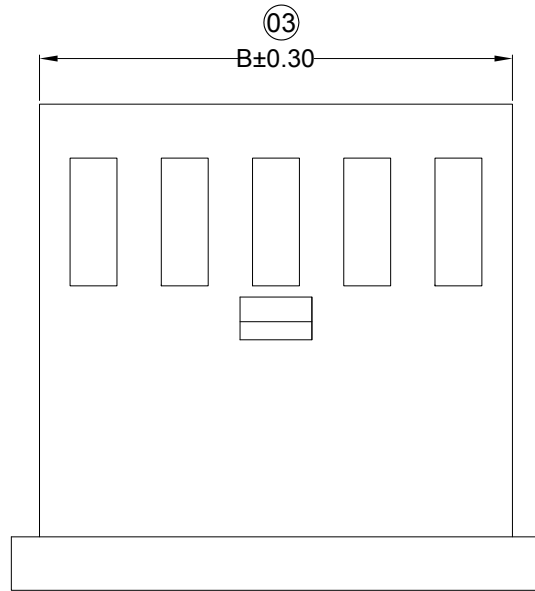
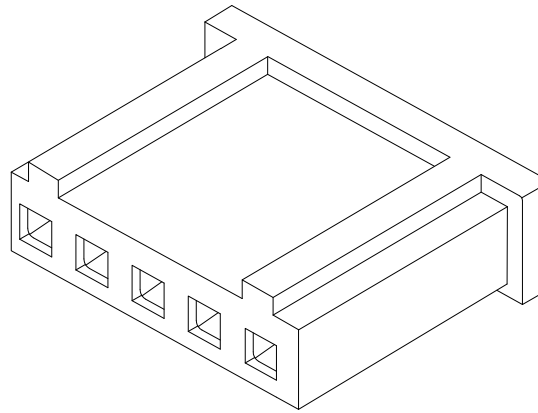
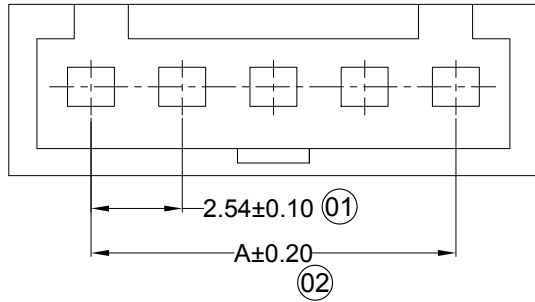

■ Specifications :

- Voltage rating: 250V AC / DC
- Current rating: 3A AC / DC
- Withstanding voltage: 800V AC/minute
- Temperature range: -25°C~+85°C
- Insulation resistance: ≥1000MΩ
- Contact resistance: ≤10mΩ
- After environmental testing: ≤20mΩ
- Mark "*" Indicate Dimensions Need To Controlled In Emphasis

2530 H X-XX X-PT XX

- ① Series No.
② Category: H-HSG
③ Welding Board Angle: Blank-ordinary
④ Row No.-Pin No.: XX-Single row
⑤ Plug the Pin & special No.
⑥ Material: PT-PBT 94V-0
⑦ Color: Blank-Natural Color

Poles	Dimensions (mm)	
	A	B
2	2.54	5.60
3	5.08	8.14
4	7.62	10.68
5	10.16	13.22
6	12.70	15.76
7	15.24	18.30
8	17.78	20.84
9	20.32	23.84
10	22.86	25.92
11	25.40	28.46
12	27.94	31.00
13	30.48	33.54
14	33.02	36.08
15	35.56	38.62
16	38.10	41.16
17	40.64	43.70
18	43.18	46.24
19	45.72	48.78
20	48.26	51.32
21	50.80	53.86
22	53.34	56.40

2530H-XX-PT	PBT UL 94V-0	2530T	2530W	1,000Pcs
PART NO	Material	Suitable SWB Terminal	Mates With SWB Wafer	Q' ty/Bag

				GENERAL TOLERANCE		 东莞市思索连接器有限公司 Terminal Connectors DongGuan Siweb Connectors CO.,LTD				PART NO. 2530H-XX-PT			
2013/08/09	B	C		Modify drawing frame format	Luna					TITLE 2.54 mm Crimp Style Connectors			
2011/09/08	A	B		Modify drawing frame format						APPROVAL	CHECK	DRAWN	DATA
DATE	OLD REV	NEW REV	ECN	DESCRIPTION	CHECK	APPROVAL	PROJECT					Liu Yan	2007/05/03
										UNIT	SCALE	NUMBER	REV
										MM	1:1	A-093	C

RoHS  Lead-free

■ Specifications :

- Voltage rating: 250V AC / DC
- Current rating: 3A AC / DC
- Withstanding voltage: 1000V AC/minute
- Temperature range: -25°C~+85°C
- Insulation resistance: ≥1000MΩ
- Contact resistance: ≤20mΩ
- After environmental testing: ≤30mΩ
- Mark "*" Indicate Dimensions Need To Controlled In Emphasis

2530 T F-P SN X-X

① ② ③ ④ ⑤ ⑥ ⑦

- ① Series Number
- ② Category: T-terminal
- ③ Shape: F-female
- ④ Material: P-Phosphor Bronze
- ⑤ Plating style: V**-All Gold-Plated
*GF-Gold Flash
*O1-1U" ; *O2-2U" ; *O3-3U" ; *O5-5U"
*10-10U" ; *15-15U" ; *30-30U" ; *50-50U"
SN-Bright tin plating 70-120U"
SW-Fog Tin plating
0-No plating material
- ⑥ Plating method: Blank-Stamping before plating
- ⑦ Mold No./Mark/Special No.

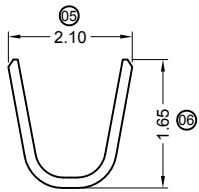
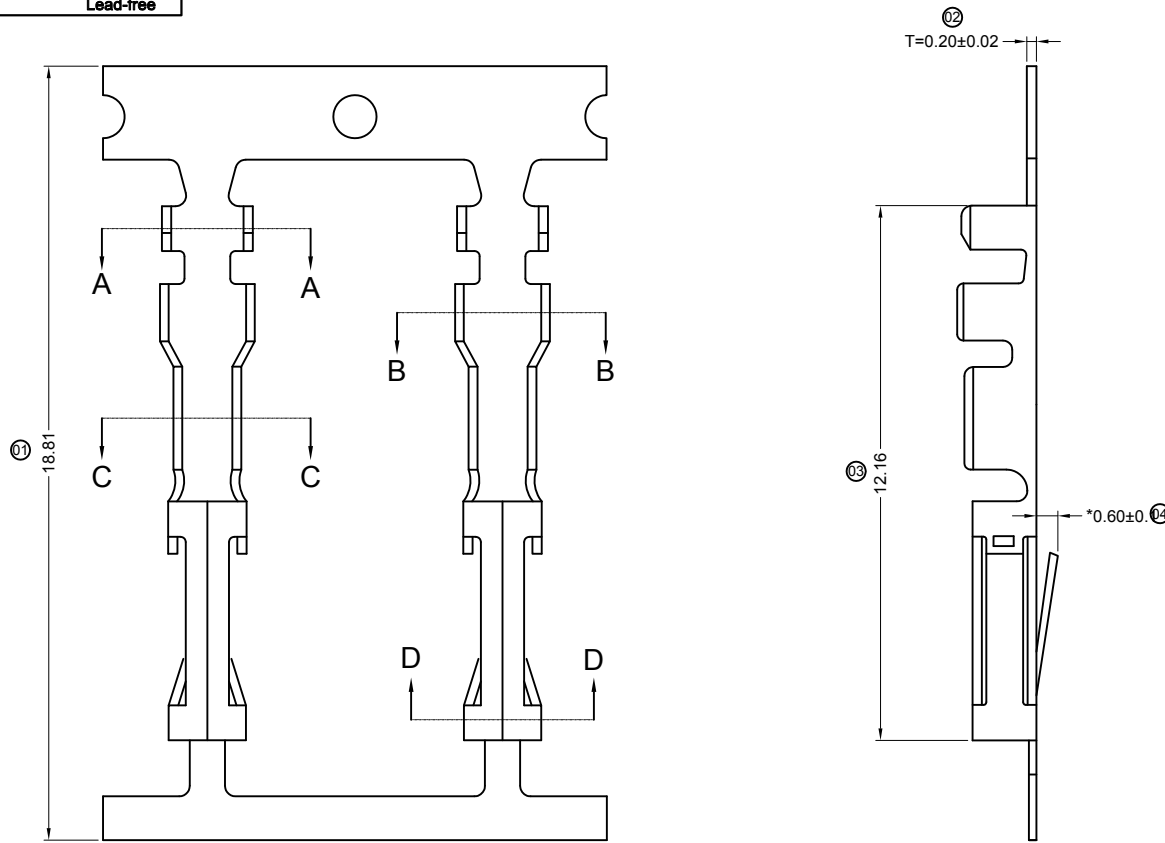

SECTION A-A
SCALE 1 : 1

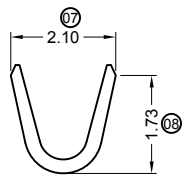

SECTION B-B
SCALE 1 : 1

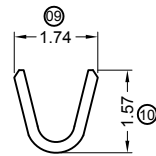

SECTION C-C
SCALE 1 : 1

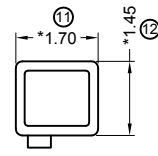

SECTION D-D
SCALE 1 : 1

2530TF-PSN	Phosphor Bronze	AWG#22-26	1.55mm(Max)	Stamping Before Plating:30~50u" Ni;70~120u"Sn	2530H	15,000Pcs
PART NO	Material	Wire Range	Insulation O.D.	Finish	Used In SWB Housing	Q' ty/Rel

				GENERAL TOLERANCE				PART NO. 2530TF-PSN						
				.X ±0.30				TITLE 2.54 mm Crimp Style Connectors						
				.XX ±0.20				APPROVAL CHECK DRAWN DATA						
				.XXX ±0.10				UNIT SCALE NUMBER REV						
DATE	OLD REV	NEW REV	ECN	DESCRIPTION	CHECK	APPROVAL	PROJECT	孙开宝	刘艳	2007/05/03	MM	1 : 1	A-001	C

SWB 东莞市思索连接器有限公司
Terminal Connectors DongGuan Siweb Connectors CO.,LTD

RoHS  Lead-free

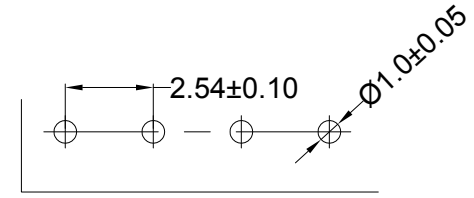
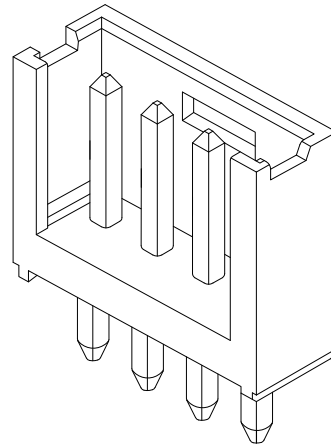
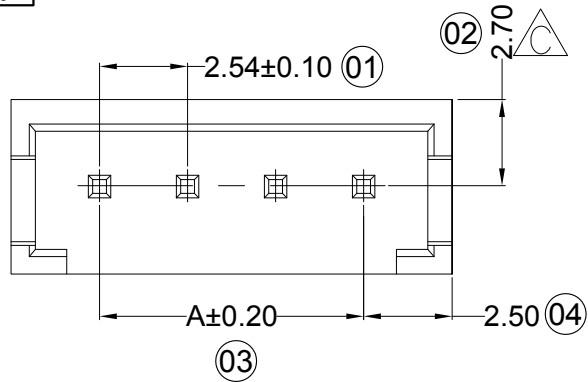

Recommened PCB Layout

■ Specifications :

- Voltage rating: 250V AC / DC
- Current rating: 3A AC / DC
- Withstanding voltage: 800V AC/minute
- Temperature range: -25°C~+85°C
- Insulation resistance: ≥100MΩ
- Contact resistance: ≤10mΩ
- After environmental testing: ≤20mΩ
- Mark***Indicate Dimensions Need To Controlled In Emphasis

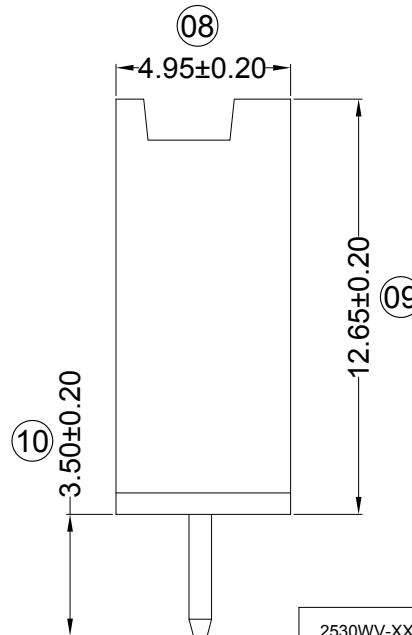
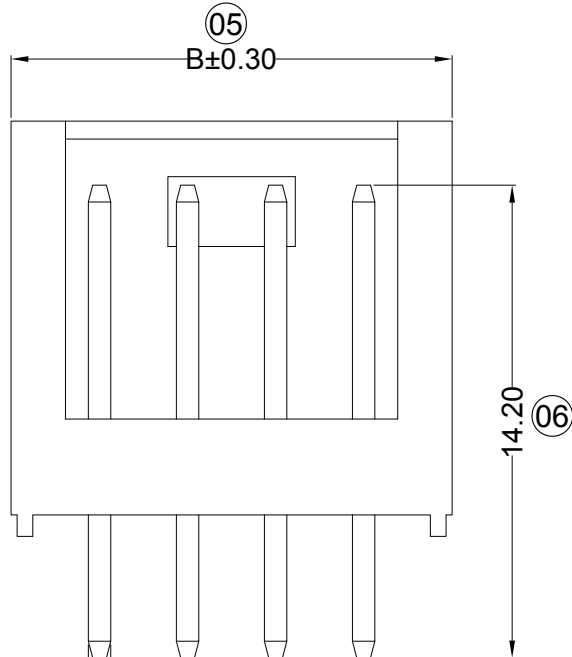

2530 W V XX- XX X-PTSN XX

① ② ③ ④ ⑤ ⑥ ⑦ ⑧ ⑨

- ① Series No.
- ② Category:
W-wafer
- ③ Welding Board Angle:
V-180°
- ④ Welding Way:
Blank-DIP
- ⑤ Row No.-Pin No.
XX-Single row
- ⑥ Special NO.
- ⑦ Material:
PT-PBT 94V-0
- ⑧ Planting Category:
V**:
V**:All Gold-Plated
*01-Gold Flash ; *02-2U" ; *03-3U" ; *05-5U"
*10-10U" ; *15-15U" ; *30-30U" ; *50-50U"
SN-Bright tin plating 70-120U"
SN1-Bright tin plating 120U"Min. ;
SW-Fog Tin plating
- ⑨ Color:
Blank-natural color

Poles	Dimensions (mm)	
	A	B
2	2.54	7.70
3	5.08	10.20
4	7.62	12.70
5	10.16	15.20
6	12.70	17.80
7	15.24	20.30
8	17.78	22.90
9	20.32	25.40
10	22.86	28.00
11	25.40	30.50
12	27.94	33.10
13	30.48	35.60
14	33.02	38.10
15	35.56	40.70
16	38.10	43.20
17	40.64	45.70
18	43.18	48.20
19	45.72	50.70
20	48.26	53.20
22	53.34	58.50

2530WV-XX-PTV01	PBT UL 94V-0	Brass	Gold-Flash	2530H	1,000Pcs
2530WV-XX-PTSN	PBT UL 94V-0	Brass	Tin-Plated		
PART NO	Material	Material(Pin)	Finish(Pin)	Mates With SWB Housing	Q' ty/Bag

DATE	OLD REV	NEW REV	ECN	DESCRIPTION	CHECK	APPROVAL	PROJECT	APPROVAL	CHECK	DRAWN	DATA	UNIT	SCALE	NUMBER	REV
2013/08/12	C	D		Modify drawing frame format	Luna		GENERAL TOLERANCE					MM	1:1	A-106	D
2013/06/25	B	C		△To increase the PIN needle size and the PIN needle center to edge of plastic shell size.			.X ±0.30								
							.XX ±0.20								
							.XXX ±0.10								

SWB 东莞市思索连接器有限公司
Terminal Connectors DongGuan Siweb Connectors CO.,LTD

PART NO. 2530WV-XX-PTXX

TITLE 2.54 mm Crimp Style Connectors

Sun Kaibao 2013/06/25

RoHS  Lead-free

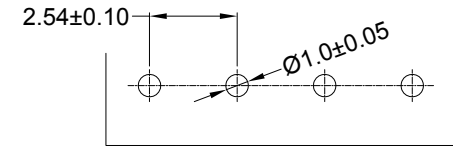
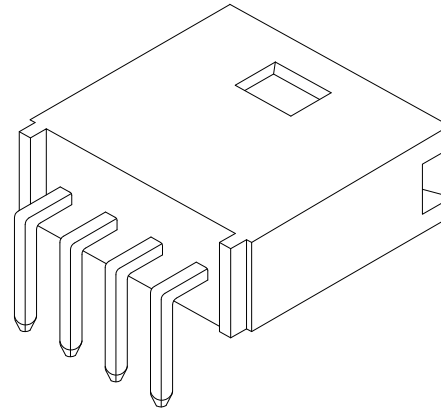
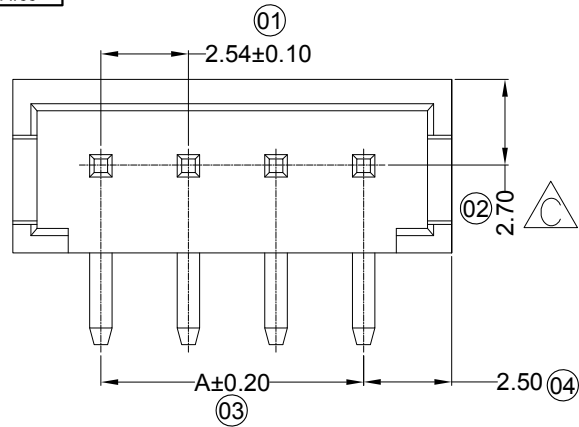

Recommend PCB Layout

■ Specifications :

- Voltage rating: 250V AC / DC
- Current rating: 3A AC / DC
- Withstanding voltage: 800V AC/minute
- Temperature range: -25°C~+85°C
- Insulation resistance: ≥1000MΩ
- Contact resistance: ≤10mΩ
- After environmental testing: ≤20mΩ
- Mark "*"Indicate Dimensions Need To Controlled In Emphasis

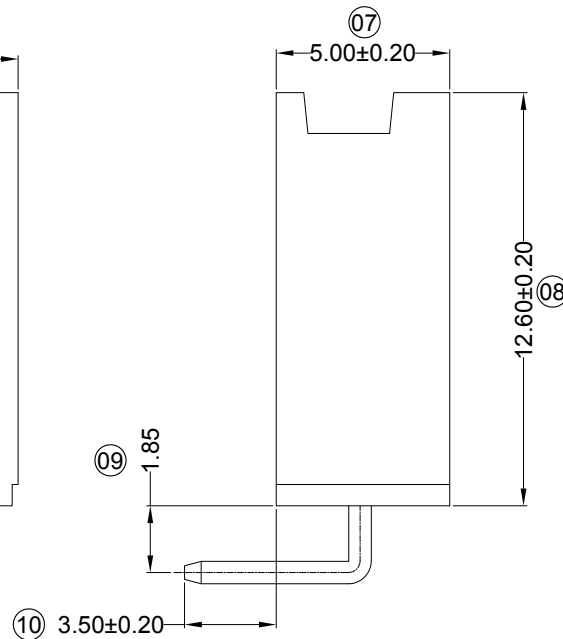
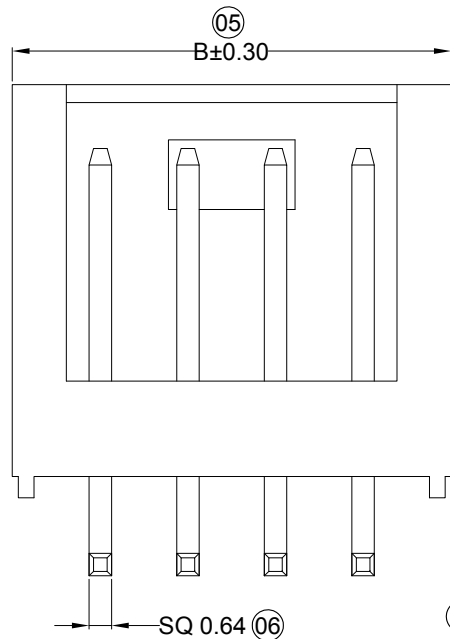

2530 W R XX- XX X-PTS N XX

① ② ③ ④ ⑤ ⑥ ⑦ ⑧ ⑨

- ① Series No.
- ② Category:
W-wafer
- ③ Welding Board Angle:
R-90°
- ④ Welding Way:
Blank-DIP
- ⑤ Row No.-Pin No.
XX-Single row
- ⑥ Special NO.
- ⑦ Material:
PT-PBT 94V-0
- ⑧ Planting Category:
V**-All Gold-Plated
*01-Gold Flash ; *02-2U" ; *03-3U" ; *05-5U"
*10-10U" ; *15-15U" ; *30-30U" ; *50-50U"
SN-Bright tin plating 70-120U"
SN1-Bright tin plating 120U"Min. ;
SW-Fog Tin plating
- ⑨ Color:
Blank-natural color

Poles	Dimensions (mm)	
	A	B
2	2.54	7.70
3	5.08	10.20
4	7.62	12.70
5	10.16	15.20
6	12.70	17.80
7	15.24	20.30
8	17.78	22.90
9	20.32	25.40
10	22.86	28.00
11	25.40	30.50
12	27.94	33.10
13	30.48	35.60
14	33.02	38.10
15	35.56	40.70
16	38.10	43.20
17	40.64	45.70
18	43.18	48.20
19	45.72	50.70
20	48.26	53.20
22	53.34	58.50

2530WR-XX-PTS N	PBT UL 94V-0	Brass	Tin-Plated	2530H	1,000Pcs
PART NO	Material	Material(Pin)	Finish(Pin)	Mates With SWB Housing	Q' ty/Bag

				GENERAL TOLERANCE		PART NO. 2530WR-XX-PTS N							
				.X ±0.30		TITLE 2.54 mm Crimp Style Connectors							
				.XX ±0.20		APPROVAL CHECK DRAWN DATA							
				.XXX ±0.10		UNIT SCALE NUMBER REV							
DATE	OLD REV	NEW REV	ECN	DESCRIPTION	CHECK	APPROVAL	PROJECT	Liu Yan	2007/05/03	MM	1:1	A-106	D

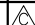
 To increase the PIN needle size and the PIN needle center to edge of plastic shell size

SWB 东莞市思索连接器有限公司
Terminal Connectors DongGuan Siweb Connectors CO.,LTD