

RoHS  Lead-free

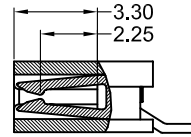

SECTION A-A  
SCALE 1:1

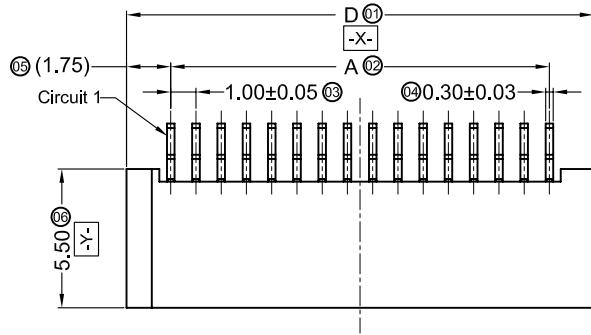
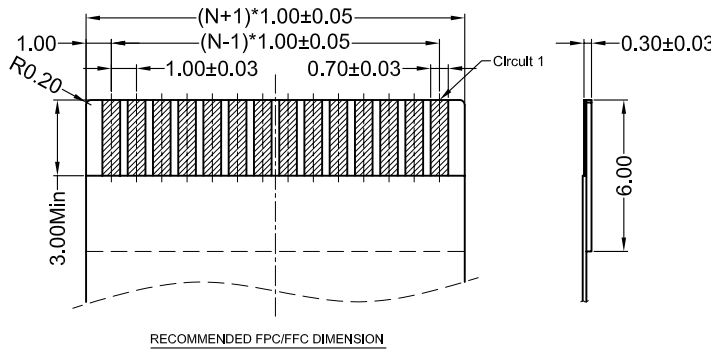
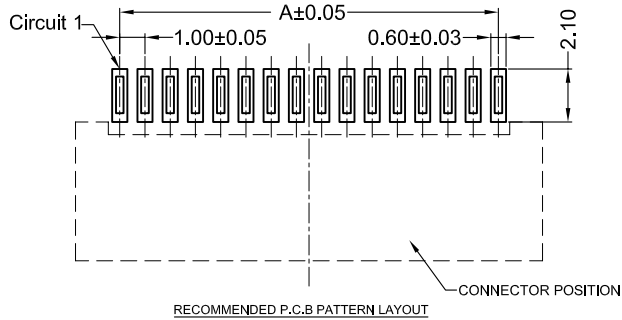
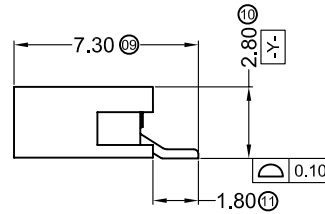
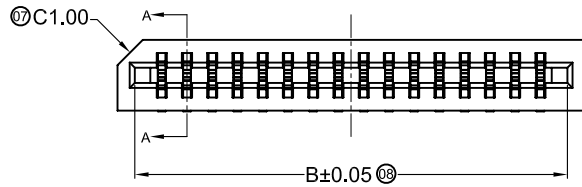

■ Specifications :

- Voltage rating: 50V AC / DC
- Current rating: 1A AC / DC
- Withstanding voltage: 500V AC/minute
- Temperature range: -25°C~+85°C
- Insulation resistance: ≥100MΩ
- Contact resistance: ≤40mΩ
- After environmental testing: ≤50mΩ

1023 W R S-XX X -LP XX XX  
① ② ③ ④ ⑤ ⑥ ⑦ ⑧ ⑨

- ① Series No
- ② Category: W-WAFER
- ③ Welding Board Angle: R-90°
- ④ Welding Way: S-SMT
- ⑤ Row No.-Pin No.: XX-Single Row
- ⑥ Plug the Pin & Special No.:
- ⑦ Material: LP -LCP 94V-0
- ⑧ Plating Category:  
G\*\*-Gold Plated Contact  
01-Gold Flash 02-2u" 03-3u"  
SN-Bright Tin Plating (70-120u")  
SW- Fog Tin Plating
- ⑨ Color : Blank-Natural Color

Poles	Dimensions(mm)				Poles	Dimensions(mm)			
	A	B	C	D		A	B	C	D
04	3.00	5.14	3.90	6.50	18	17.00	19.14	17.90	20.50
05	4.00	6.14	4.90	7.50	19	18.00	20.14	18.90	21.50
06	5.00	7.14	5.90	8.50	20	19.00	21.14	19.90	22.50
07	6.00	8.14	6.90	9.50	21	20.00	22.14	20.90	23.50
08	7.00	9.14	7.90	10.50	22	21.00	23.14	21.90	24.50
09	8.00	10.14	8.90	11.50	23	22.00	24.14	22.90	25.50
10	9.00	11.14	9.90	12.50	24	23.00	25.14	23.90	26.50
11	10.00	12.14	10.90	13.50	25	24.00	26.14	24.90	27.50
12	11.00	13.14	11.90	14.50	26	25.00	27.14	25.90	28.50
13	12.00	14.14	12.90	15.50	27	26.00	28.14	26.90	29.50
14	13.00	15.14	13.90	16.50	28	27.00	29.14	27.90	30.50
15	14.00	16.14	14.90	17.50	29	28.00	30.14	28.90	31.50
16	15.00	17.14	15.90	18.50	30	29.00	31.14	29.90	32.50
17	16.00	18.14	16.90	19.50					

1023WRS-XX-LPSN	LCP UL 94V-0	Phosphor Bronze	Tin-Plated
1023WRS-XX-LPG01	LCP UL 94V-0	Phosphor Bronze	Gold Flash
PART NO	Material	Material(Pin and Solder tabs)	Finish(Pin and Solder tabs)

GENERAL TOLERANCE  
.X ±0.30  
.XX ±0.20  
.XXX ±0.10



思索连接器有限公司  
SWB CONNECTORS CO.,LTD

PART NO. 1023WRS-XX-LPXX

TITLE 1.00 mm FPC Style Connectors

PROJECT 

APPROVAL	CHECK	DRAWN	DATA
Bob Sun	Jova Lau	Sylvia	2014/02/10

UNIT	SCALE	NUMBER	REV
MM	1:1	A-106	A

DATE	OLD REV	NEW REV	ECN	DESCRIPTION	CHECK	APPROVAL
1			2			4